

PRESQUE ISLE HARBOR DEVELOPMENT

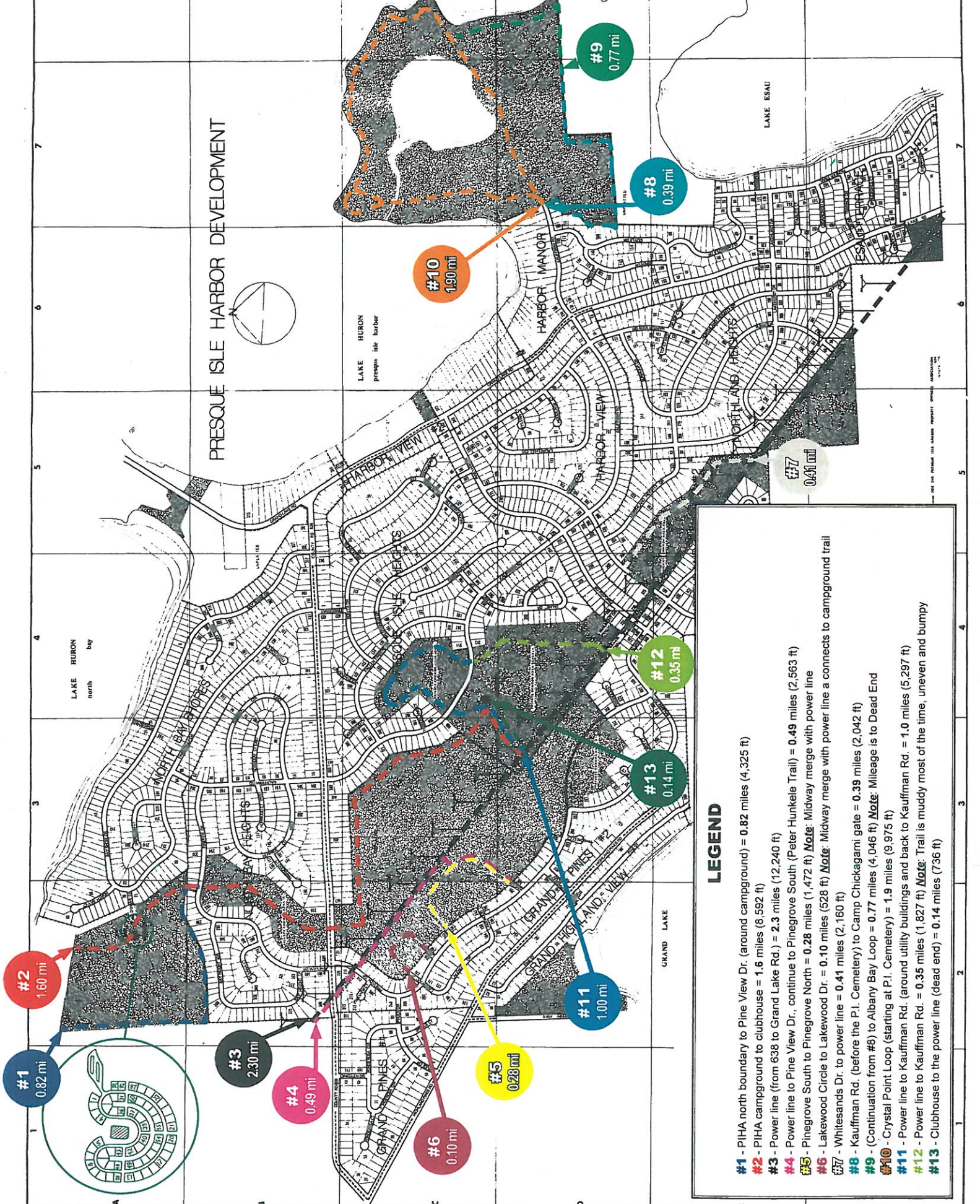

LEGEND

- #1 - PIHA north boundary to Pine View Dr. (around campground) = 0.82 miles (4,325 ft)
- #2 - PIHA campground to clubhouse = 1.6 miles (8,592 ft)
- #3 - Power line (from 638 to Grand Lake Rd.) = 2.3 miles (12,240 ft)
- #4 - Power line to Pine View Dr., continue to Pinegrove South (Peter Hunkele Trail) = 0.49 miles (2,563 ft)
- #5 - Pinegrove South to Pinegrove North = 0.28 miles (1,472 ft) **Note:** Midway merge with power line
- #6 - Lakewood Circle to Lakewood Dr. = 0.10 miles (528 ft) **Note:** Midway merge with power line a connects to campground trail
- #7 - Whitesands Dr. to power line = 0.41 miles (2,160 ft)
- #8 - Kauffman Rd. (before the P.I. Cemetery) to Camp Chickagami gate = 0.39 miles (2,042 ft)
- #9 - (Continuation from #8) to Albany Bay Loop = 0.77 miles (4,046 ft) **Note:** Mileage is to Dead End
- #10 - Crystal Point Loop (starting at P.I. Cemetery) = 1.9 miles (9,975 ft)
- #11 - Power line to Kauffman Rd. (around utility buildings and back to Kauffman Rd. = 1.0 miles (5,297 ft)
- #12 - Power line to Kauffman Rd. = 0.35 miles (1,827 ft) **Note:** Trail is muddy most of the time, uneven and bumpy
- #13 - Clubhouse to the power line (dead end) = 0.14 miles (736 ft)